

**TOOL GRINDING MACHINES
MACHINE TOOL ACCESSORIES
MACHINE VICES**



DRILL GRINDING MACHINE

- ❑ Quick re-sharpening of HSS or carbide drills of taper or straight shank.
- ❑ Two separate stations for point angle grinding and relieving.
- ❑ Very easy to learn operation by instruction sheet.
- ❑ CBN grinding wheel for HSS drills and all size collets included as standard equipment. SDC grinding wheel for carbide drill and additional collets are optional.
- ❑ Electrically controlled and powerful DC motor: stable frequency, strong horsepower and long service life.
- ❑ Point angle can be set as per material to be drilled.



MODEL	DRILL DIA CAPACITY	DIA CAP WITH OPTIONAL COLLETS	STANDARD EQUIPMENT INCLUDED	OPTIONAL EQUIPMENT	POINT ANGLE	POWER & SPEED	WEIGHT & DIMENSIONS(cm)
SDG-13	Ø3 - Ø13	Ø3 - Ø15	Collets 11pcs (Ø3-Ø13) ER20 Collet Chuck (Ø2-Ø14)	Collets: Ø2, Ø2.5, Ø3.5, Ø4.5, Ø5.5, Ø14, Ø15 Collet Chuck: Ø15	90°-140°	AC-220V/120W 4400rpm	9 Kg 32 X 18 X 19
SDG-20	Ø3 - Ø20	—	Collets 11pcs Er20 (Ø3-Ø13), Collets 7pcs ER25 (Ø14-Ø20) Collet Chuck (Ø3-Ø13) Collet Chuck (Ø14-Ø20)	Collets: Ø2.5, Ø3.5, Ø4.5, Ø5.5	90°-140°	AC-220V/120W 4400rpm	11 Kg 32 X 19 X 20
SDG-26	Ø13 - Ø26	Ø8 - Ø32	Collets 14pcs (Ø13-Ø26) ER40 Collet Chuck (Ø8-Ø30)	Collets: Ø8, Ø9, Ø10, Ø11, Ø12, Ø27, Ø28, Ø29, Ø30, Ø31, Ø32, Collet Chuck: Ø31-Ø32	90°-140°	AC-220V/250W 4400rpm	31kg 49 x 25 x 26

Grinding Wheel: SD (for Carbide Drills) Available as Optional

LABELLED DIAGRAM OF MACHINE

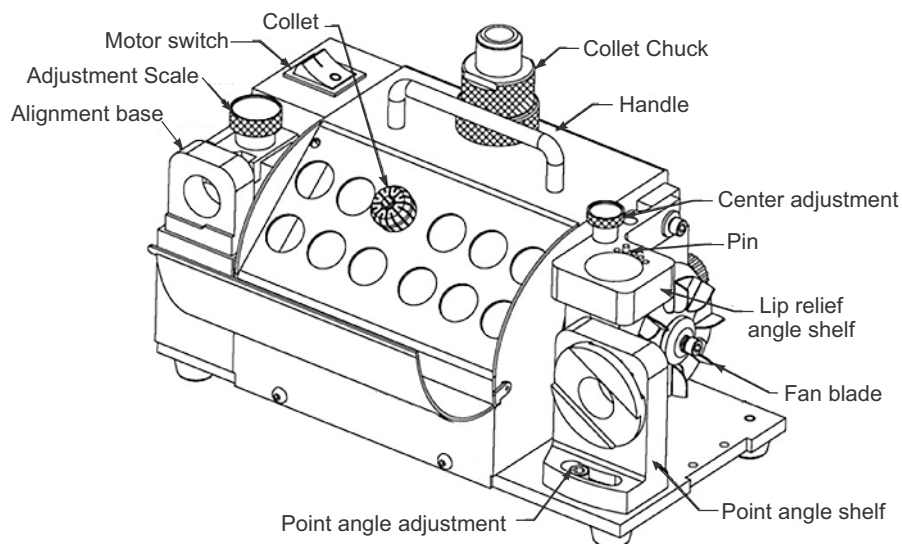

GROUND DRILL BIT

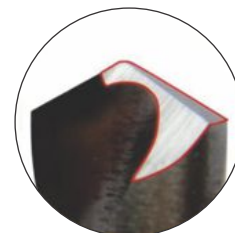

Point Angle



Lip Relief

DRILL GRINDING MACHINE - PS SERIES WITH 3RD GRINDING OPERATION OF POINT SPLITTING FOR MORE ACCURATE DRILLING

- ❑ Quick re-sharpening of HSS or carbide drills of taper or straight shank.
- ❑ Three separate stations for point angle grinding, lip relief, and point splitting
- ❑ Point splitting enables accurate start, stable and speedy drilling
- ❑ Very easy to learn operation by instruction sheet.
- ❑ CBN grinding wheel for HSS drills and all size collets included as standard equipment.
SDC grinding wheel for carbide drill and additional collets are optional.
- ❑ Electrically controlled and powerful DC motor: stable frequency, strong horsepower and long service life.



MODEL	DRILL DIA CAPACITY	DIA CAPACITY WITH OPTIONAL COLLETS	NO. OF COLLETS	OPTIONAL EQUIPMENT	POINT ANGLE	POWER & SPEED	WEIGHT & DIMENSIONS(cm)
SDG-13-PS	Ø3 - Ø13	Ø3 - Ø15	collets 11pcs (Ø3-Ø13) ER20 Collet Chuck (Ø2-Ø14)	Collets: Ø2, Ø2.5, Ø3.5, Ø4.5, Ø5.5, Ø14, Ø15 Collet Chuck: Ø15	90°-140°	AC-220V/120W 4400rpm	9 Kg 32 X 18 X 19
SDG-26-PS	Ø13 - Ø26	Ø8-Ø32	collets 14pcs (Ø13-Ø26) ER40 Collet Chuck (Ø8-Ø30)	Collets: Ø8, Ø9, Ø10, Ø11, Ø12, Ø27, Ø28, Ø29, Ø30, Ø31, Ø32, Collet Chuck: Ø31-Ø32	90°-140°	AC-220V/250W 4400rpm	31 Kg 49 X 25 X 26

Grinding wheel: SD (for Carbide drills) available as optional

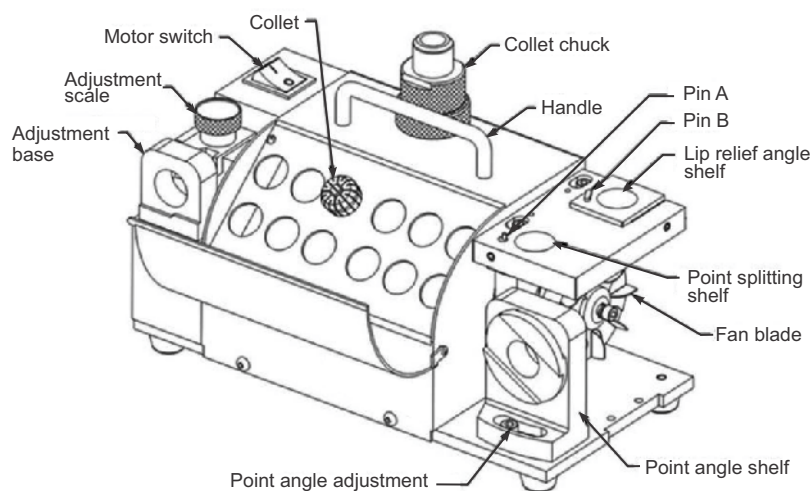
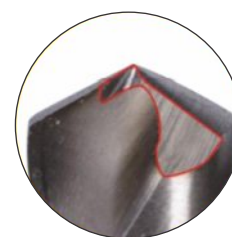
LABELLED DIAGRAM OF MACHINE

GROUND DRILL BIT

Point Angle



Lip Relief



Point Splitting

END MILL GRINDING MACHINE

- ❑ Quick re-sharpening of HSS or carbide end mills.
- ❑ Very easy to learn operation by instruction sheet.
- ❑ SDG grinding wheel for carbide end mills and all size collets included as standard equipment. CBN grinding wheel for HSS end mills and additional collets are optional.
- ❑ Grinds 2-Flute, 3-Flute, 4-Flute, end mills and bigger than 12 dia 6-Flute end mills.
- ❑ Electrically controlled and powerful DC motor: stable frequency, strong horse power and long service life.

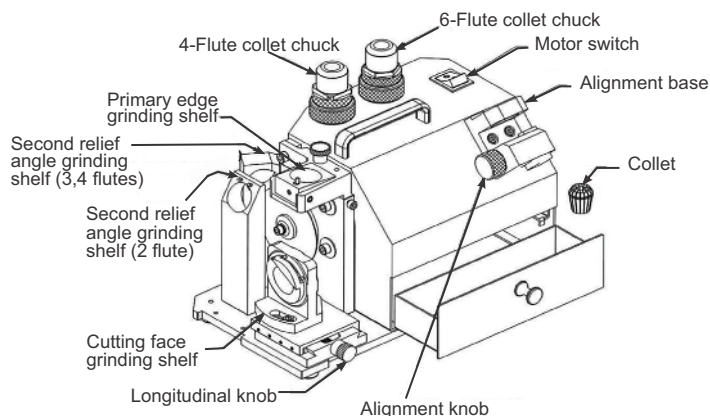

MODEL	DRILL DIA CAPACITY	POINT ANGLE	POWER & SPEED	WEIGHT & DIMENSIONS(cm)	STANDARD EQUIPMENT	OPTIONAL EQUIPMENT
SEM-14	Ø4 - Ø14	0°-5°	AC-220V/120W 4400rpm	16 kg 35 X 23 X 24	One piece grinding wheel: SDC(for Carbide)×1 Six collets: φ4, φ6, φ8, φ10, φ12, φ14 Two collet chucks: 2,4 flutes ×1 piece; 3,6 flutes ×1 piece	Grinding wheel: CBN (for HSS)
SEM-20	Ø4 - Ø20	0°-5°	AC-220V/120W 4400rpm	20 kg 35 X 23 X 24	One piece grinding wheel: SDC230 (for Carbide)×1 (4-14φ) One piece grinding wheel: SDC150 (for Carbide)×1 (15-20φ) Six ER20 collets: φ4, φ6, φ8, φ10, φ12, φ14 Three ER25 collets: φ16, φ18, φ20 Four collet chucks: 2,4 flutes ×1 piece (4-14mm) 3,6 flutes×1 piece (4-14mm) 2,4 flutes ×1 piece (14-20mm) 3,6 flutes×1 piece (14-20mm)	Grinding wheel: CBN230 (for HSS) CBN150 (for HSS)
SEM-30	Ø12 - Ø30	0°-5°	AC-220V/250W 4000rpm	28 kg 40 X 28 X 31	One piece grinding wheel: SDC (for Carbide)×1 Ten collets: φ12, φ14, φ16, φ18, φ20, φ22, φ24, φ26, φ28, φ30 Two collet chucks: 2, 4 flutes×1 piece; 3,6 flutes ×1 piece	Grinding wheel: CBN (for HSS)

GROUND END MILL



END MILL GRINDING MACHINE WITH PRESET ANGLES

New model of end mill grinding machine with all angles preset to industry standards. No angle adjustment required, extremely easy to use for an unskilled person.

- ❑ Point angle set at 2°

MODEL	DRILL DIA CAPACITY	POWER & SPEED	WEIGHT & DIMENSIONS(cm)
SEM-14-PA	Ø4 - Ø14	AC-220V/120W 4400rpm	16 kg 35 X 23 X 24
SEM-20-PA	Ø4 - Ø20	AC-220V/120W 4400rpm	20 kg 35 X 23 X 24

Standard & optional equipment for SEM-PA series the same as given in the table above of SEM series.



ELECTRIC TAPPING MACHINE VERTICAL / UNIVERSAL

- ❑ The machine adopts a servo drive control with intelligent torque protection.
- ❑ Advanced design, rigid construction.
- ❑ The high definition touch screen is simple and flexible. It can realize the vertical and horizontal work of complex and heavy workpiece, locate quickly, and process accurately.
- ❑ Adjustable speed, manual / automatic modes of work, whatever you choose.
- ❑ Automatic mode can effectively control the depth of tapping, without the operation button, automatic control by depth controller.
- ❑ Repeated positioning, fast tapping speed, high production efficiency.



MODEL	VOLT.	POWER	RPM	TAPPING RANGE	WORKING RANGE (VERTICAL)	WORKING RANGE (HORIZONTAL)	ISO COLLETS INCLUDED	NET WEIGHT
SETM-16-V Vertical Head SETM-16-U Universal Head	220V/50HZ	600 W	0-312	M3-M16 (Steel) M3-M20(Aluminum)	1050mm (vertical head type) 1100mm (Universal head type)	540mm (adjustable)	M3,M4,M5,M6-8,M10,M12,M14,M16	25 KG
SETM-30-V Vertical Head SETM-30-U Universal Head	220V/50HZ	1200 W	0-200	M6-M30(Steel) M6-M36(Aluminum)	1100mm (Vertical head type) 1200mm (Universal head type)	570mm (adjustable)	M6-8,M10,M12,M14,M16,M18-20,M22,M24,M30	42 KG
SETM-36-V Vertical Head SETM-36-U Universal Head	220V/50HZ	1200 W	0-156	M6-M36(Steel) M6-M40(Aluminum)	1100mm (Vertical head type) 1200mm (Universal head type)	570mm (adjustable)	M6-8,M10,M12,M14,M16,M18-20,M22,M24,M30,M33,M36	43 KG
Standard Equipment	ISO collets, wrench 1 piece, power cable							

Optional Accessories

The magnetic seat has 4 mounting holes on one side for the electric tapping machine and a powerful magnet on the other side to mount on any ferrous surface of the machine or directly on a large workpiece.

MODEL	CAPACITY (kg)	PULLING FORCE MAX. (kgs)	CYLINDRICAL WORK LIMIT	
			DIAMETER(mm)	WEIGHT (kg)
SMST-300	300	1000	≥ 60	≤ 100
SMST-600	600	1800	≥ 70	≤ 100

MAGNETIC SEAT



WORK TABLE



MODEL	SIZE	WEIGHT
SWT-8050	800X500 mm	70 kg
SWT-9060	900X600 mm	85 kg

SIDE MILL TYPE CHAMFERING MACHINE

- ❑ Most suitable for chamfering of workpieces such as moulds, machine parts: steel, cast iron etc.
- ❑ Chamfering is done by milling cutter having indexable carbide inserts.
- ❑ Size of chamfer is adjustable.



MODEL	CHAMFERING ANGLE	POWER	SPEED	CHAMFERING DEPTH	OVERALL DIMENSIONS	WEIGHT	STANDARD EQUIPMENT
SMCM-R300	15°- 45°	550W, 380V 50HZ	2800 rpm	0-3mm	54 X 39 X 30 cm	36 kg	Indexable insert type cutter

ANGLOCK MILLING VICE

- Suitable for general milling, CNC milling, machining center.
- Parallelism and square within 0.025mm/100mm.
- Special segment mechanism minimizes jaw lift and workpiece tilt.
- Ductile iron construction for high durability.
- Thrust bearing for easy handle movement.

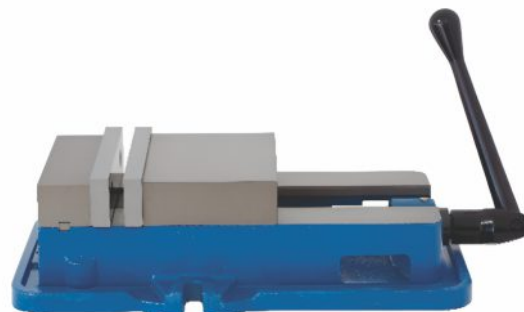
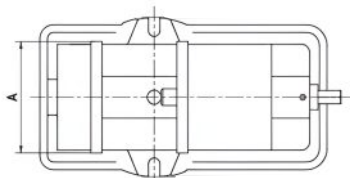
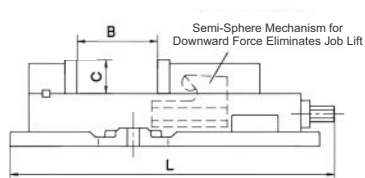

MODEL	JAW WIDTH A	JAW DEPTH C	MAX JAW OPENING B	OVERALL LENGTH L
SLV - 4	100	32	115	330
SLV - 6	160	45	160	430
SLV - 6L	160	45	195	472
SLV - 8	200	50	210	530
SLV - 8L	200	50	300	595

ALL ABOVE MODELS AVAILABLE WITH OR WITHOUT SWIVEL BASE.

COMPACT ANGLOCK VICE

- This is a compact version of Anglock Milling Vice.
- Suitable for CNC milling and machining center.
- Parallelism and square within 0.020mm/100mm.
- Special segment mechanism minimizes jaw lift and workpiece tilt.
- Ductile iron construction for high durability.
- Thrust bearing for easy handle movement.

MODEL	JAW WIDTH	JAW DEPTH	MAX JAW OPENING	OVERALL LENGTH
SCLV - 6	160	45	160	440

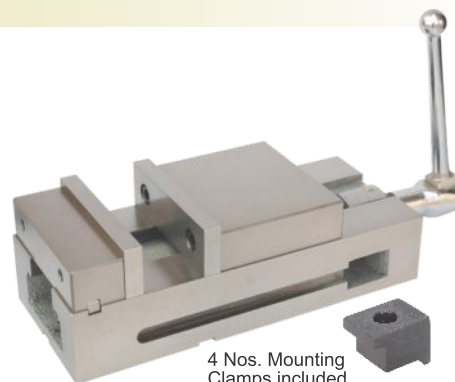

4 Nos. Mounting Clamps included

DOUBLE STATION MACHINE VICE WITH SELF CENTERING FUNCTION

- Suitable for CNC milling machine, machining center.
- Two workpieces of unequal sizes upto a difference of 45mm can be clamped.

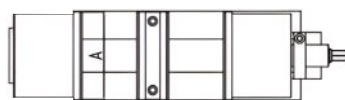
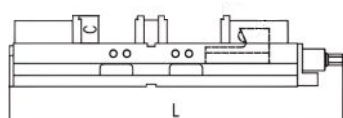

Remove the fixed jaw to make self-center vise, MAX E

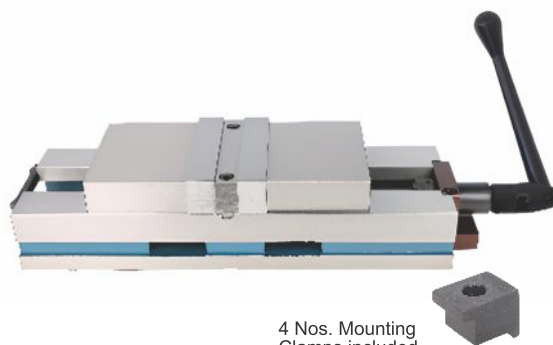
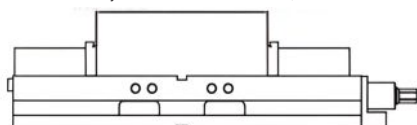

4 Nos. Mounting Clamps included

MODEL	JAW WIDTH A	JAW DEPTH C	MAX JAW OPENING 1	MAX JAW OPENING 2	SELF CENTERING MIN	SELF CENTERING MAX. E	OVERALL LENGTH L
SDSV-6	160	45	90	110	45	255	610

TWO-WAY ANGLE MILLING VICE

- ❑ Made of high grade cast iron.
- ❑ The vice can be adjusted and locked at any angle from the horizontal position to the vertical position and also has a swivelling base with rotation of 360°.

MODEL	JAW WIDTH	JAW DEPTH	MAX JAW OPENING	OVERALL LENGTH	OVERALL HEIGHT	OVERALL WIDTH
STW-4	100	40	85	300	145	180
STW-5	125	45	100	370	150	230
STW-6	160	50	125	420	190	250



THREE-WAY ANGLE MILLING VICE

- ❑ Made of high grade cast iron.
- ❑ Other than the vertical tilting and 360° rotation, this vice also has tilting on the third side. All three angles are adjustable.
- ❑ Tie rod eliminates vibration during operation.

MODEL	JAW WIDTH	JAW DEPTH	MAX JAW OPENING
SVW - 4	105	40	105
SVW - 5	125	44	120



QUICK ACTION DRILL VICE

- ❑ Most suitable for production setups on drilling or light milling operations.
- ❑ Rapid clamping/locking and quick release of workpiece saves cycle time.
- ❑ It uses a double parallel guide rods structure for movable jaw.
- ❑ Eccentric locking mechanism for rigid clamping.

MODEL	JAW WIDTH	JAW DEPTH	MAX JAW OPENING
SQV - 100	100	38	160



DRILL MACHINE VICE - HEAVY DUTY

- ❑ Movable jaw guided on a precision slide for rigid and precise clamping.
- ❑ Heavy cast iron construction.

MODEL	JAW WIDTH	JAW DEPTH	MAX JAW OPENING
SDV - 100	105	46	110
SDV - 150	155	52	155



ELECTRONIC (OPTICAL) EDGE FINDER WITH LED AND BEEPER

SOGGO electronic edge finder with LED is the most convenient to use, as the ball probe comes in contact with the job, the red light powered by an enclosed battery glows along with a beeping sound.

- ☐ Concentricity of ball-probe and shank within 0.005mm.
- ☐ Repeatability of work location within 0.01mm.
- ☐ Spring loaded ball-probe to prevent damage of probe.

MODEL	SHANK DIA	BALL DIA	TOTAL LENGTH	TYPE
STSOE-20LB	20	10	160	with LED and Beeper



Z-AXIS ZERO SETTER - Model SZ-50

Z-Axis Zero Setter is used for zero setting of tool height from the machine table on machining centers. Setting height: 50.00 ± 0.01 mm

Features:

- ☐ Large measuring surface to assure high measuring accuracy.
- ☐ Low Spring force to avoid breakage of small end mill and drill.
- ☐ Easy to calibrate by a ground parallel or gauge block.

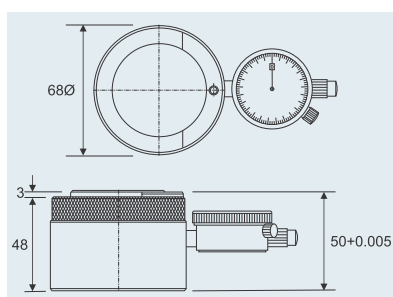

BORING HEAD SETS WITH INDEXABLE INSERT TYPE BORING TOOLS

Sets available with different interchangeable shanks such as R8, NT30, NT40, NT50, MT2, MT3, MT4, MT5, BT40 & BT50.

MODEL	MIN BORING DIA	MAX BORING DIA	MAX BORING DEPTH	BORING BAR HOLE SIZE	BORING HEAD OUTER DIA	BORING HEAD LEAST COUNT	NO. OF BORING TOOLS
SBHC-2-6	10	150	50	12 mm	50	0.02	6
SBHC-3-7	10	250	65	18 mm	75	0.02	7



SINE PLATE WITH MAGNETIC CHUCK

Accuracy 0.005mm in parallelism, squareness and center distance of rollers.

MODEL	MAGNETIC TOP SIZE	OVERALL HEIGHT IN CLOSED POSITION	TILTING
SSP47M	175 X 100	87	0 – 45°
SSP66M	150 X 150	87	0 – 45°
SSP510M	250 X 125	87	0 – 45°
SSP612M	300 X 150	87	0 – 45°



RADIUS AND ANGLE DRESSER

Radius and angle dresser is a precision grinding wheel dresser on any type of surface or tool & cutter grinding machine to dress the grinding wheel to any desired form - any combination of tangents and radius - either convex or concave as shown below. Radius is set very precisely with the help of slip gauges or by measuring over the twin pins with micrometer. Concave radius or Convex radius is determined by using either the left or right hand pins.

Max. concave R is 60mm

Max. convex R is 150mm

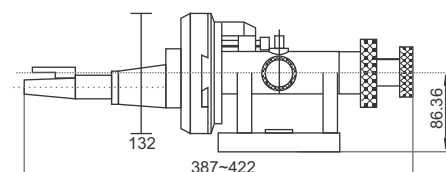
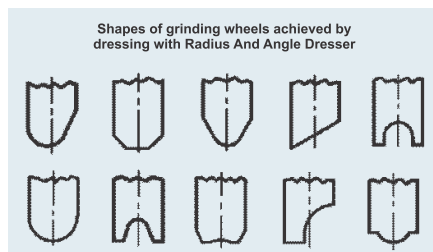

MODEL	MAX DIA OF GRINDING WHEEL	INSERTING HOLE DIAMOND DRESSER	OVERALL LENGTH	MOUNTING BASE
SRDB	300	3/8 INCH	387	134x105

UNIVERSAL DRESSER

Universal dresser is adaptable to surface grinder or universal tool grinder for radius and angle dressing.

SETTING OF R:

R is zero when H = L

To dress convex R: $H = L + R$

To dress concave R: $H = L - R$

Wheel Dressing Applications

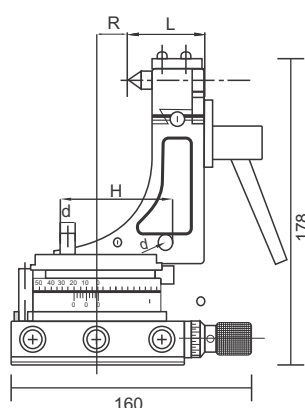

MODEL	CENTER HEIGHT	MAX SWING DISTANCE OF DRESSER	MAX GRINDING WHEEL DIA	MAX TRANSLATION OF FEED	FEED PER DIVISION OF HANDLE SCALE
SWD-165	165 mm	± 20 mm	200 mm	20 mm	0.02 mm

HORIZONTAL AND VERTICAL ROTARY TABLE

Available in different sizes from 110Ø to 400Ø. Can be mounted horizontally as well as vertically.

MODEL	TABLE DIA
SHV-4	110
SHV-6	150
SHV-8	200
SHV-10	250
SHV-12	300
SHV-14	350
SHV-16	400

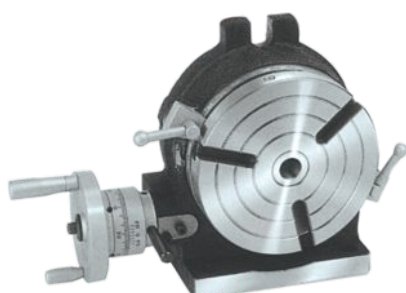

PERMANENT MAGNETIC LIFTER

'SOGGO' High power permanent magnets ensure steady power for an unlimited period. All lifting magnets are tested as per safety factor of 1:3.5.

MODEL	LIFTING CAPACITY
SPML- 100	110 kgs
SPML- 300	300 kgs
SPML- 600	600 kgs
SPML- 1000	1000 kgs
SPML- 2000	2000 kgs
SPML- 3000	3000 kgs



ER SPRING COLLETS as per DIN 6499

All below given sizes of ER Collets are available in single piece packing.

Collet Type	Size - Diameter Range (mm)
ER16	1-0.5, 1.5-1, 2-1.5, 3-2, 4-3, 5-4, 6-5, 7-6, 8-7, 9-8, 10-9
ER 20	1-0.5, 1.5-1, 2-1.5, 3-2, 4-3, 5-4, 6-5, 7-6, 8-7, 9-8, 10-9, 11-10, 12-11, 13-12
ER 25	1-0.5, 1.5-1, 2-1.5, 3-2, 4-3, 5-4, 6-5, 7-6, 8-7, 9-8, 10-9, 11-10, 12-11, 13-12, 14-13, 15-14, 16-15
ER 32	1-0.5, 1.5-1, 2-1.5, 3-2, 3.5-2.5, 4-3, 5-4, 6-5, 7-6, 8-7, 9-8, 10-9, 11-10, 12-11, 13-12, 14-13, 15-14, 16-15, 17-16, 18-17, 19-18, 20-19
ER 40	3-2, 4-3, 5-4, 6-5, 7-6, 8-7, 9-8, 10-9, 11-10, 12-11, 13-12, 14-13, 15-14, 16-15, 17-16, 18-17, 19-18, 20-19, 21-20, 22-21, 23-22, 24-23, 25-24, 26-25, 27-26, 28-27, 29-28, 30-29



ER COLLETS AND COLLET CHUCK SETS

Following sizes of ER Collet & Collet Chuck sets with spanner in an attractive plastic carry box are available.



Collet Chuck Set With Spanner	15 Pieces Collet Sizes Included In Set
ER 32 - BT - 30	3-2, 4-3, 5-4, 6-5, 7-6, 8-7, 9-8, 10-9, 12-11, 14-13, 15-14, 16-15, 17-16, 18-17, 20-19
ER 32 - BT - 40	3-2, 4-3, 5-4, 6-5, 7-6, 8-7, 9-8, 10-9, 12-11, 14-13, 15-14, 16-15, 17-16, 18-17, 20-19
ER 32 - BT - 50	3-2, 4-3, 5-4, 6-5, 7-6, 8-7, 9-8, 10-9, 12-11, 14-13, 15-14, 16-15, 17-16, 18-17, 20-19
ER 40 - BT - 40	3-2, 4-3, 5-4, 6-5, 8-7, 10-9, 12-11, 14-13, 15-14, 16-15, 18-17, 20-19, 22-21, 24-23, 26-25
ER 40 - BT - 50	3-2, 4-3, 5-4, 6-5, 8-7, 10-9, 12-11, 14-13, 15-14, 16-15, 18-17, 20-19, 22-21, 24-23, 26-25

ER SPANNER

Following spanners are available for tightening and loosening collet chucks of respective sizes.

Sizes
ER25 - Star Type
ER32 - Star Type
ER40 - Star Type



Star Type

PULL STUDS - MAS 403

Following sizes of Pull Studs are available:

Sizes	Sizes
PS - BT30 - 30°	PS - BT40 - 45°
PS - BT30 - 45°	PS - BT50 - 30°
PS - BT40 - 30°	PS - BT50 - 45°



ER COLLECT CHUCKS

Hardened high grade steel, precision ground.

Sizes	Sizes
BT30 - ER16 x 60	BT40 - ER32 x 70
BT30 - ER20 x 60	BT40 - ER32 x 100
BT30 - ER25 x 60	BT40 - ER40 x 80
BT30 - ER32 x 60	BT50 - ER16 x 70
BT30 - ER40 x 70	BT50 - ER20 x 70
BT40 - ER16 x 70	BT50 - ER25 x 80
BT40 - ER20 x 70	BT50 - ER32 x 80
BT40 - ER25 x 70	BT50 - ER40 x 80



SIDE LOCK ADAPTOR (End Mill Holder)

Hardened high grade steel, precision ground.

Sizes	Sizes
BT40 - SLA 8 dia x 65	BT40 - SLA 32 dia x 90
BT40 - SLA 10 dia x 65	BT40 - SLA 40 dia x 90
BT40 - SLA 12 dia x 65	BT50 - SLA 20 dia x 105
BT40 - SLA 16 dia x 65	BT50 - SLA 25 dia x 105
BT40 - SLA 20 dia x 90	BT50 - SLA 32 dia x 105
BT40 - SLA 25 dia x 90	BT50 - SLA 40 dia x 105



SHELL MILL ARBOR

Hardened high grade steel, precision ground.

Sizes	Sizes
BT40 - 22 dia x 60	BT40 - 32 dia x 60
BT40 - 22 dia x 90	BT50 - 27 dia x 90
BT40 - 27 dia x 60	BT50 - 32 dia x 75
BT40 - 27 dia x 105	



HORIZONTAL / VERTICAL CNC TOOL TIGHTENING FIXTURE

Used for tightening the tool in the tool holder outside the machine.

Model	Taper
TTF-BT-30	BT-30
TTF-BT-40	BT-40
TTF-BT-50	BT-50

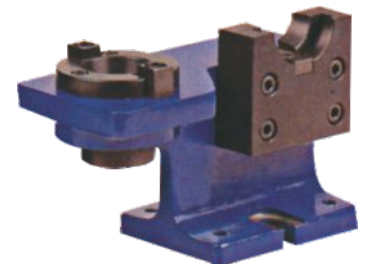

UNIVERSAL ARM MAGNETIC STAND : Model MS-80

- ☐ Rigid locking of the stand by one central knob.
- ☐ Magnetic Base with ON / OFF Switch size : H55 x W50 x L63.
- ☐ Magnetic Pull : 80 Kgs.
- ☐ Dial Holder hole ID = 8mm with micro adjustment.
- ☐ Main stem height = 290 mm.





ABBOTT TOOLFAST PVT. LTD.

Plot No. 16, Sector - 27 A, Faridabad - 121002, Haryana, India

Ph.: +91-129-4042237, 4133981, 4133982

Email: toolfast@toolfastclamps.com, marketing@toolfastclamps.com

Website: www.toolfastclamps.com

Distributor: